

PLANT SPACING
DETAIL
(NO-OFFSET)

CLEARWATER INDEX No. 903, SH. 1 of 2
 Rev. 8/05/05
 N.T.S.

				CITY OF CLEARWATER, FLORIDA ENGINEERING DEPARTMENT		
2	5/17/12	DEPARTMENT NAME	TLM	REDRAWN BY PWD	PLANT SPACING DETAIL (NO-OFFSET)	DATE 7/15/99
1	8/05/05	CHANGED SETBACK	TMK	CHECKED BY TMK		INDEX NO. 903
REV.	DATE	DESCRIPTION	APP.	DESIGNED BY TMK		1 OF 2

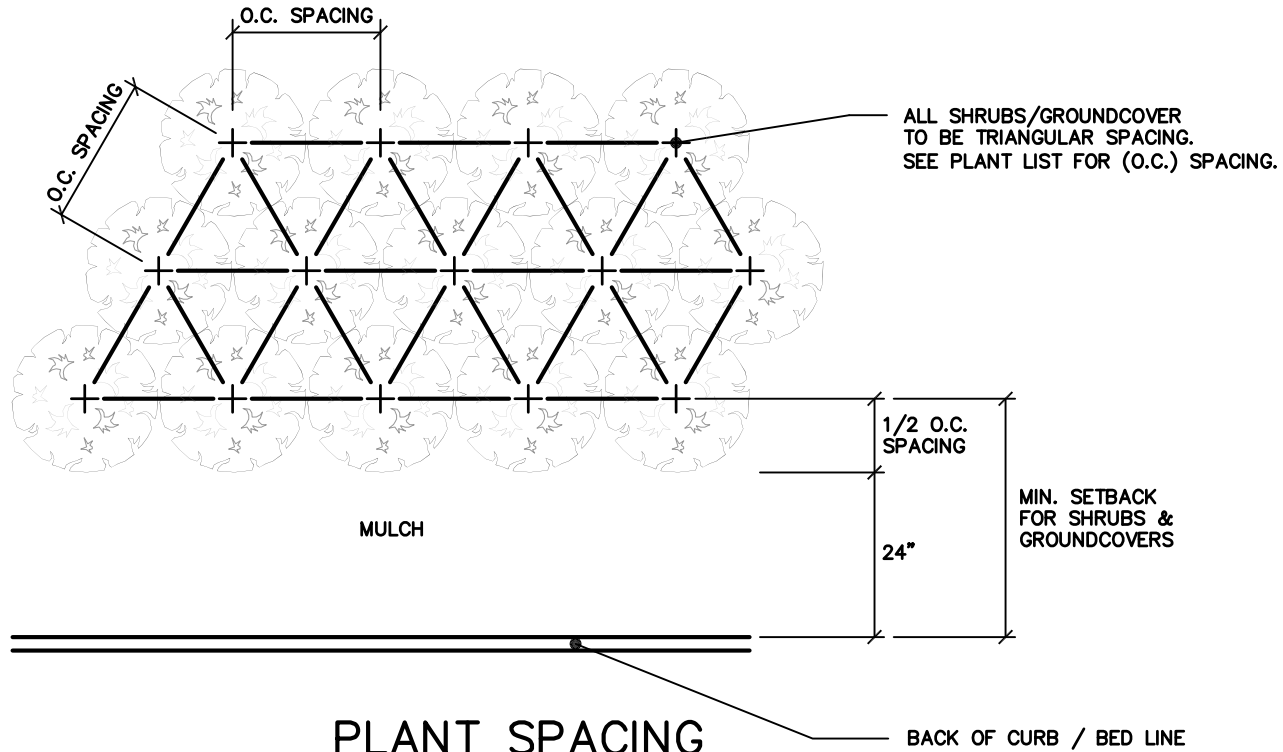

PLANT SPACING
DETAIL
(24" OFFSET)

CLEARWATER INDEX No. 903, SH. 2 of 2
 Rev. 8/05/05
 N.T.S.

				CITY OF CLEARWATER, FLORIDA ENGINEERING DEPARTMENT	
				REDRAWN BY P.W.D.	DATE 8/05/05
				CHECKED BY T.M.K.	INDEX NO. 903
				DESIGNED BY T.M.K.	2 OF 2
1	5/17/12	DEPARTMENT NAME	TLM	PLANT SPACING DETAIL (24" OFFSET)	
REV.	DATE	DESCRIPTION	APP.		

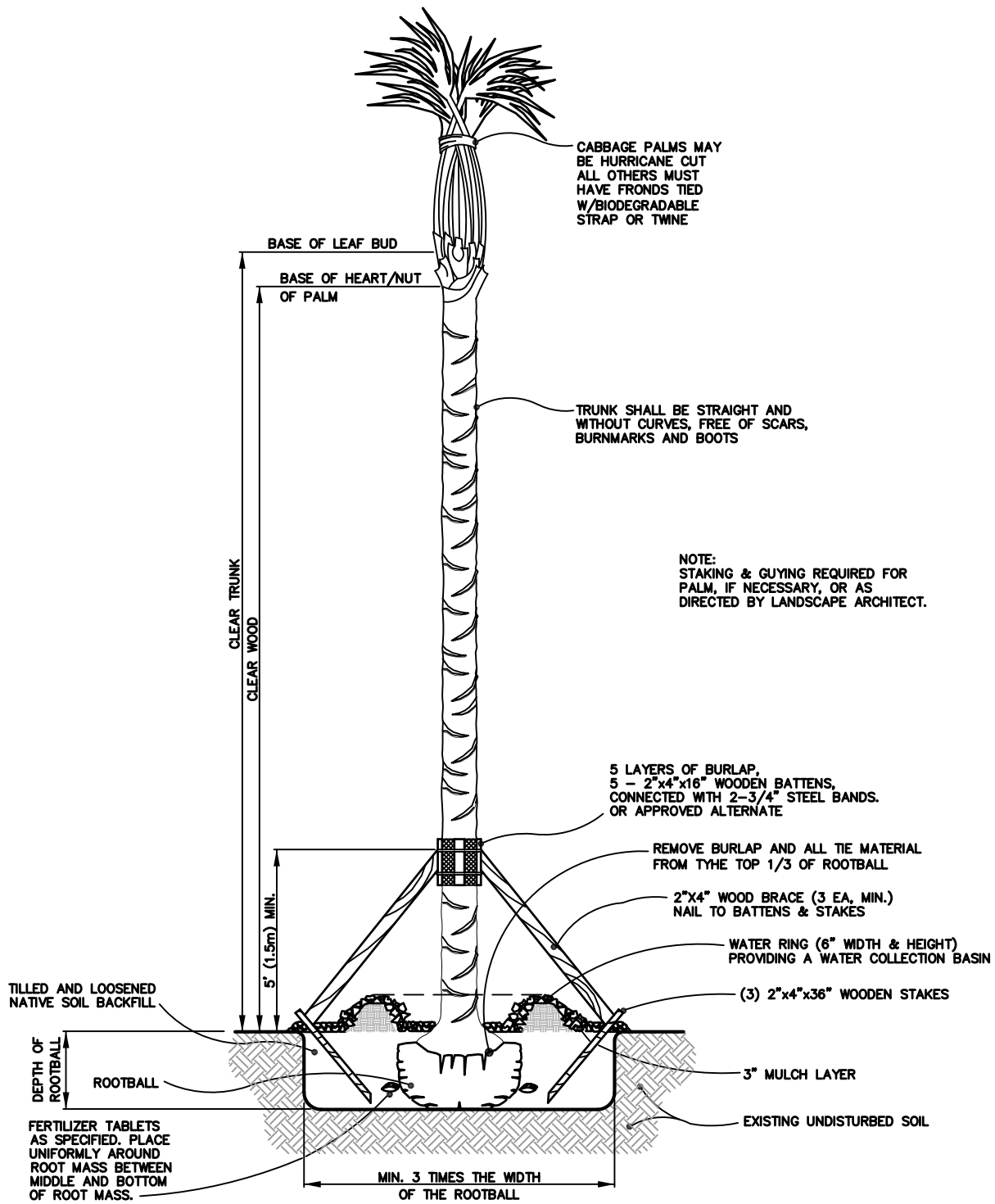

PALM PLANTING DETAIL

CLEARWATER INDEX No. 904, SH. 1 of 1
Rev. 8/21/06
N.T.S.

				CITY OF CLEARWATER, FLORIDA ENGINEERING DEPARTMENT		
				REDRAWN BY PWD	PALM PLANTING DETAIL	DATE 3/30/00
2	5/17/12	DEPARTMENT NAME	TLM	CHECKED BY TMK		INDEX NO. 904
1	8/06	ADDITIONS & CORRECTIONS	TMK	DESIGNED BY TMK		1 OF 1
REV.	DATE	DESCRIPTION	APP.			

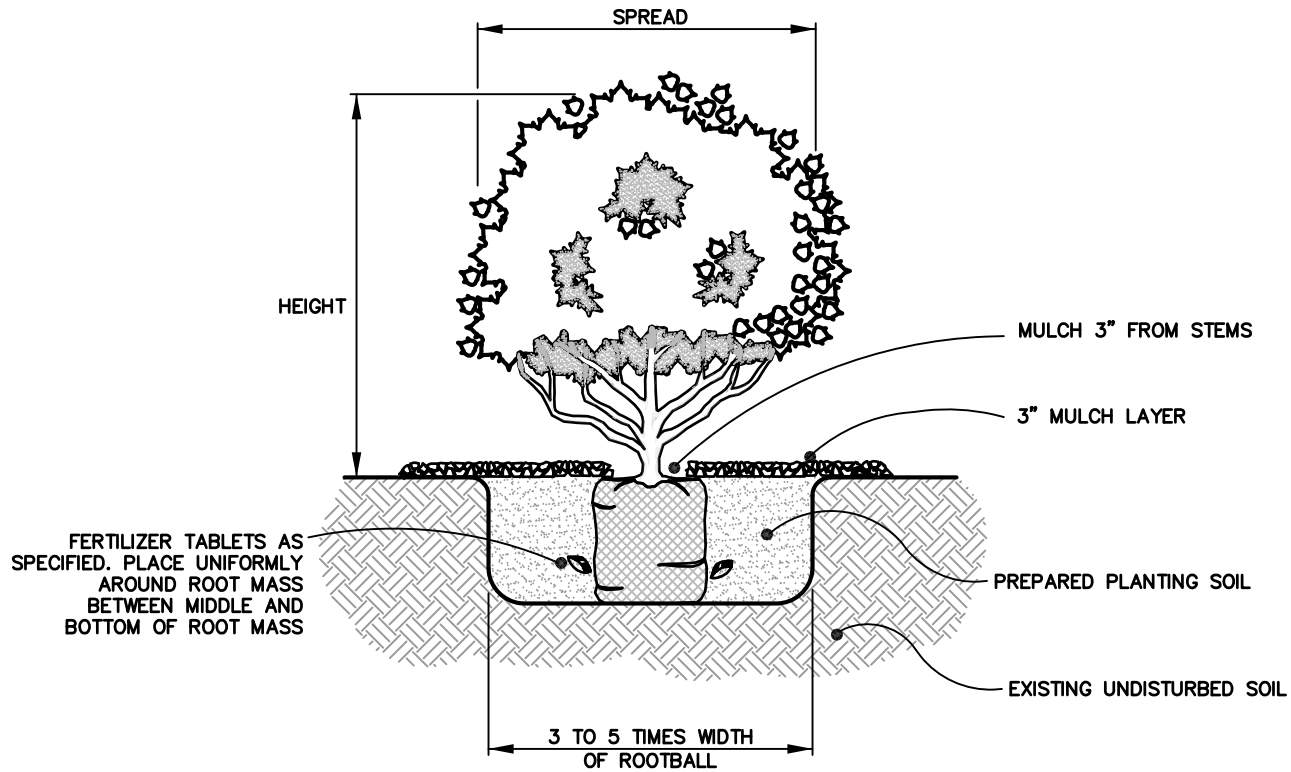

SHRUB & GROUNDCOVER PLANTING DETAIL

CLEARWATER INDEX No. 905, SH. 1 of

1

Rev. 7/15/99

N.T.S.

				CITY OF CLEARWATER, FLORIDA ENGINEERING DEPARTMENT	
				REDRAWN BY PWD	DATE 7/15/99
				CHECKED BY TMK	INDEX NO. 905
				DESIGNED BY TMK	1 OF 1
REV.	DATE	DESCRIPTION	APP.	SHRUB & GROUNDCOVER PLANTING DETAIL	
1	5/17/12	DEPARTMENT NAME	TLM		

GENERAL LANDSCAPE NOTES

1. The Landscape Contractor shall grade planting beds, as required, to provide positive drainage and promote optimum plant growth.
2. All recommended trees and plant materials will be graded as Nursery Grade No. 1 or better as outlined by the Florida Department of Agriculture and Consumer Services, Division of Plant Industry "Grades and Standards for Nursery Plants", 7th Edition, 1998 as revised from time to time.
3. All planting shall be done in accordance with the Florida Nurserymen's and Grower's Associations approved practices.
4. All plants shall be fertilized with Agriform 20-10-5 tablets as per the manufacturers specifications in conjunction with note # 5.
5. The planting soil shall be the approximate proportions as follows: 50% sand and 50% organic material consisting of native peat, well-decomposed sawdust, leaf mold and top soil. It shall provide a good pliable and thoroughly mixed medium with adequate aeration, drainage and water-holding capacity. It shall also be free of all extraneous debris, such as roots, stones, weeds, etc.
6. All planting areas shall receive a 3" layer of recycled hardwood log mulch, which is to be watered-in after installation.
7. The plant material schedule is presented for the convenience of the Landscape Contractor. In the event of a discrepancy between the plan and the plant key, the plan shall prevail.
8. Plants shall meet size, container, and spacing specifications. Any material not meeting specifications shall be removed and replaced at the contractor's expense.
9. All tree and shrub locations are subject to change. All locations shall be approved by the City Project Manager prior to planting.
10. The Landscape Contractor shall be responsible for examining fully both the site and the bid documents. Discrepancies in the documents or the actual site conditions shall be reported to the City Project Manager in writing at the time of bidding or discovery. No account shall be made after contract completion for failure to report such condition, or for errors on the part of the Landscape Contractor at the time of bidding.
11. The Landscape Contractor shall be responsible for securing all necessary applicable permits and licenses to perform the work set forth in this plan set and the specifications.
12. Plant material shall be bid as specified unless unavailable, at which time the City Project Manager will be notified by telephone and in writing of intended changes.
13. Any and all questions concerning the plan set and/or specifications shall be directed to the City Project Manager at (727) 562-4737.
14. There shall be no additions, deletions or substitutions without the written approval of the City Project Manager.
15. The Landscape Contractor shall guarantee, in writing, plant survivability for a period of twelve (12) months from final acceptance by the City Project Manager.
16. All dimensions to be field-checked by the Landscape Contractor prior to landscape material installation. Discrepancies shall be reported immediately to the City Project Manager.
17. All materials must be as specified on the landscape plan. If materials or labor do not adhere to specifications, they will be rejected by the City Project Manager with proper installation carried out by Landscape Contractor at no additional cost.
18. All permits necessary are to be provided by the installing contractor unless otherwise specifically stated in the specifications.
19. No contractor identification signs shall be permitted on the project, except for the project information signs.
20. Existing sod shall be removed as necessary to accommodate new plantings.
21. Any existing sod areas that are unnecessarily disturbed during the landscape installation shall be resodded to match existing.
22. The Landscape Contractor will be responsible for the collection, removal, and proper disposal of any and all debris generated during the installation of this project.

				CITY OF CLEARWATER, FLORIDA ENGINEERING DEPARTMENT		
				REDRAWN BY P.W.D.	GENERAL LANDSCAPING	DATE 3/30/00
				CHECKED BY T.M.K.	NOTES	INDEX NO. 906
1	5/17/12	DEPARTMENT NAME	TLM	DESIGNED BY T.M.K.		1 OF 3
REV.	DATE	DESCRIPTION	APP.			

IRRIGATION NOTES

1. A low volume irrigation system, that provides 100% coverage to all proposed plantings, will be designed and installed by the Contractor.
2. The proposed Irrigation System must meet or exceed all applicable City code requirements. (i.e., Back Flow Prevention, Automatic Rain Shutoff Device, etc...)
3. Irrigation shop drawings must be submitted and approved by the City prior to the Commencement of work.
4. Irrigation system must be inspected and accepted by City Project Manager prior to installation of mulch.
5. Irrigation as-built drawings, which accurately and clearly identify all modifications &/or substitutions, must be submitted prior to final inspection and acceptance.
6. The existing 5/8" water meter will be utilized for this Irrigation System.
7. The Landscape Contractor must coordinate the placement and power supply for the irrigation control timer with the City and the General Contractor.
8. The following irrigation system components will be utilized, per each manufacturers' specifications.

Toro–Netafim TechLine Self Cleaning, Pressure–Compensating Emitter Line
 HARDIE – Raindial 6 Station Outdoor Control Timer
 Richdale – 214APR 1" Electric Valve
 Amtec – 10" Round Valve Box.

				CITY OF CLEARWATER, FLORIDA ENGINEERING DEPARTMENT		
				REDRAWN BY P.W.D.	IRRIGATION	DATE 7/15/99
				CHECKED BY T.M.K.	NOTES	INDEX NO. 906
1	5/17/12	DEPARTMENT NAME	TLM	DESIGNED BY T.M.K.		2 OF 3
REV.	DATE	DESCRIPTION	APP.			

FERTILIZATION NOTES

SHRUBS AND TREES

All trees and shrubs shall be fertilized with "Agriform" 20-15-5 planting tablets at time of installation and prior to completion of pit backfilling. Tablets shall be placed uniformly around the root mass at a depth that is between the middle and bottom of the root mass.

APPLICATION RATE:

1 Gallon can:	1 - 21 gram tablet
3 Gallon can:	2 - 21 gram tablets
5 Gallon can:	3 - 21 gram tablets
7 Gallon can:	4 - 21 gram tablets

Trees:	3 - 21 gram tablets each 1/2" of caliper
Palms:	7 - 21 gram tablets

GROUNDCOVER AREAS

All groundcover areas shall receive fertilization with "OzmoCote" time release fertilizer as per manufacturer's specifications.

				CITY OF CLEARWATER, FLORIDA ENGINEERING DEPARTMENT		
				REDRAWN BY P.W.D.	FERTILIZATION	DATE 7/15/99
				CHECKED BY T.M.K.	NOTES	INDEX NO. 906
1	5/17/12	DEPARTMENT NAME	TLM	DESIGNED BY T.M.K.		3 OF 3
REV.	DATE	DESCRIPTION	APP.			

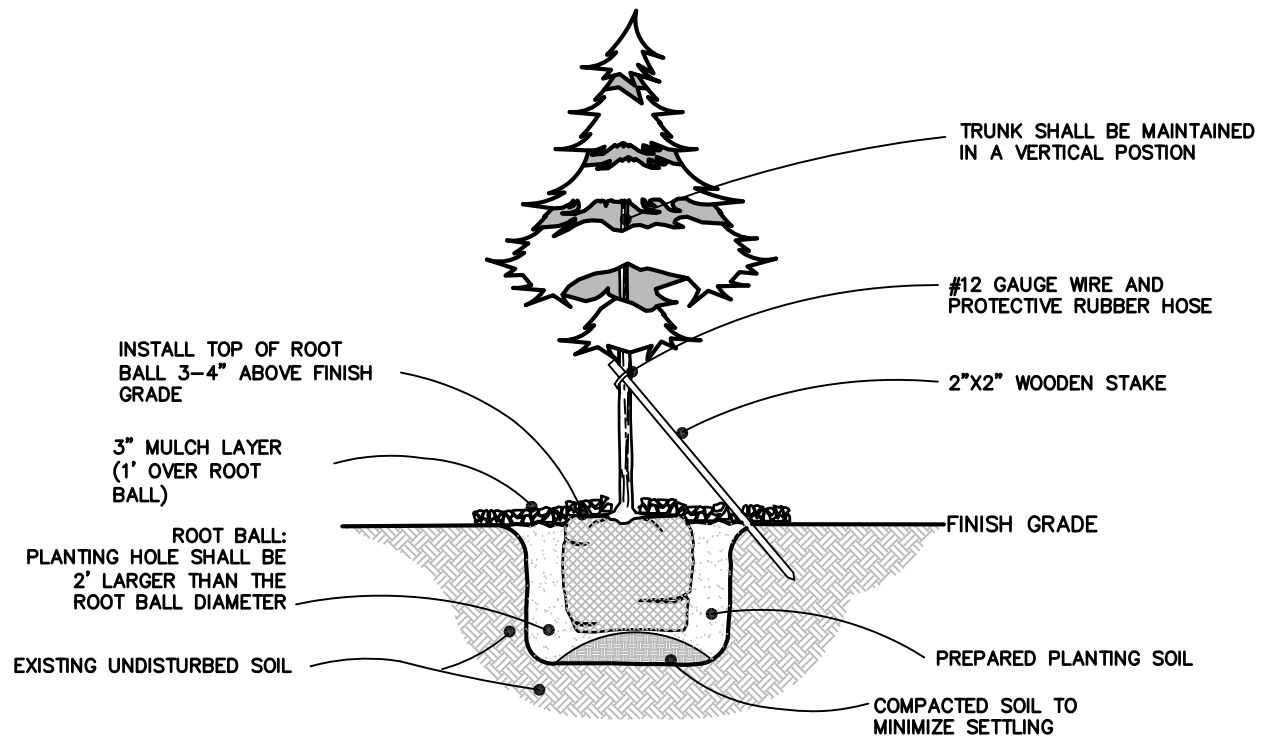

PINE TREE PLANTING DETAIL

CLEARWATER INDEX No. 907, SH. 1 of 1

Rev. 7/23/99

N.T.S.

				CITY OF CLEARWATER, FLORIDA ENGINEERING DEPARTMENT	
				REDRAWN BY P.W.D.	DATE 7/23/99
				CHECKED BY T.M.K.	INDEX NO. 907
				PINE TREE PLANTING DETAIL	
1	5/17/12	DEPARTMENT NAME	TLM	DESIGNED BY T.M.K.	1 OF 1
REV.	DATE	DESCRIPTION	APP.		

NOTES:

1. ALL WOOD SHALL BE SPRUCE OR PINE—NOT PRESSURE TREATED.
2. CROSS TIES SHALL NOT CROSS OVER WOODY ROOTS.
3. REMOVE ALL STRING &/OR WIRE WRAPPED AROUND TRUNK.
4. REMOVE ALL STRAPS, ROPES, WIRE, &/OR STRINGS USED TO LIFT THE ROOTBALL.
5. REMOVE ALL BURLAP &/OR WIRE FROM THE TOP OF THE ROOT BALL.
- △ 6. TOP OF ROOTBALL TO BE SET LEVEL WITH SURROUNDING FINISH GRADE.

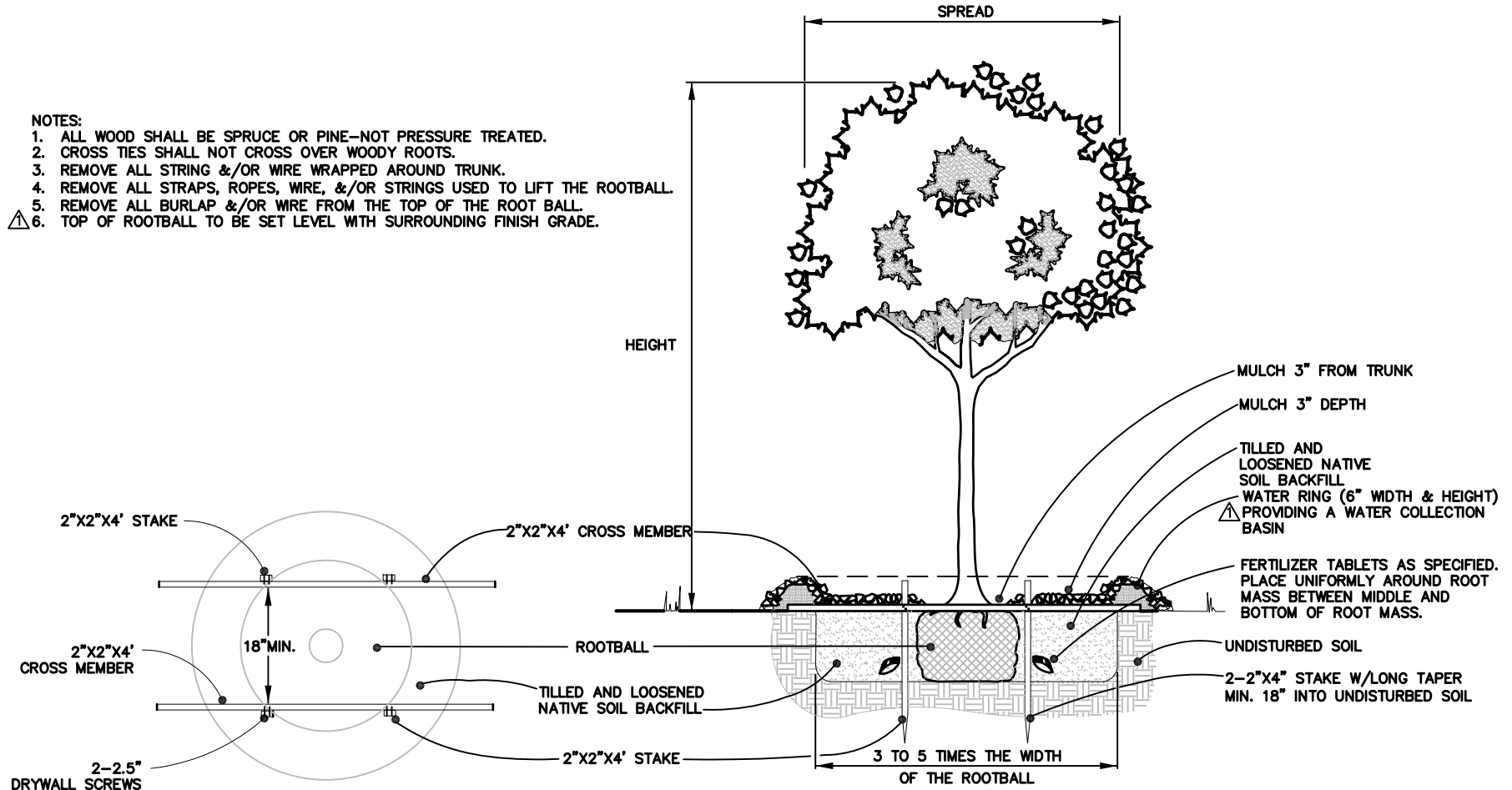

**TREE PLANTING
DETAIL**

CLEARWATER INDEX No. 908, SH. 1 of 1
Rev. 8/16/06
N.T.S.

				CITY OF CLEARWATER, FLORIDA ENGINEERING DEPARTMENT		
2	5/17/12	DEPARTMENT NAME	TLM	REDRAWN BY PWD	TREE PLANTING DETAIL	DATE 3/30/00
1	8/06	ADDITIONS & CORRECTIONS	TMK	CHECKED BY TMK		INDEX NO. 908
REV.	DATE	DESCRIPTION	APP.	DESIGNED BY TMK		1 OF 1

HARDWOODS

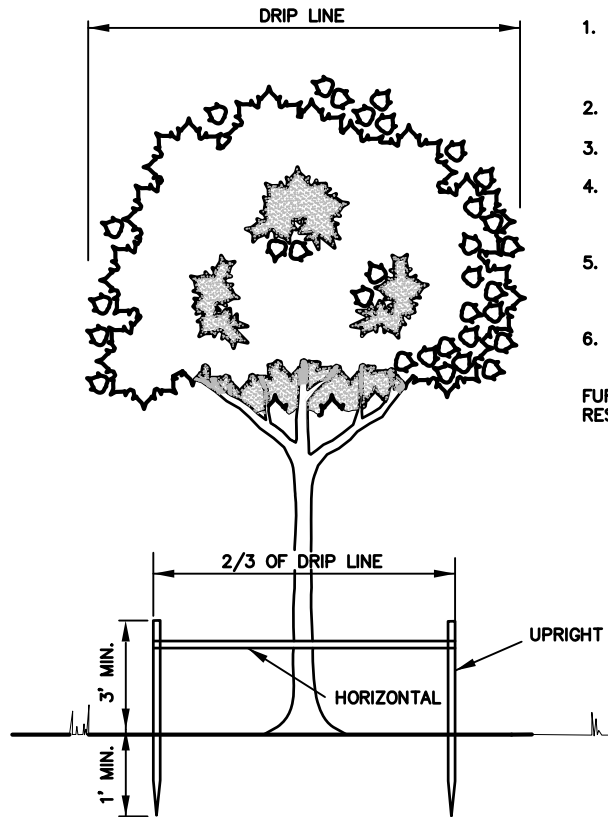

PINES

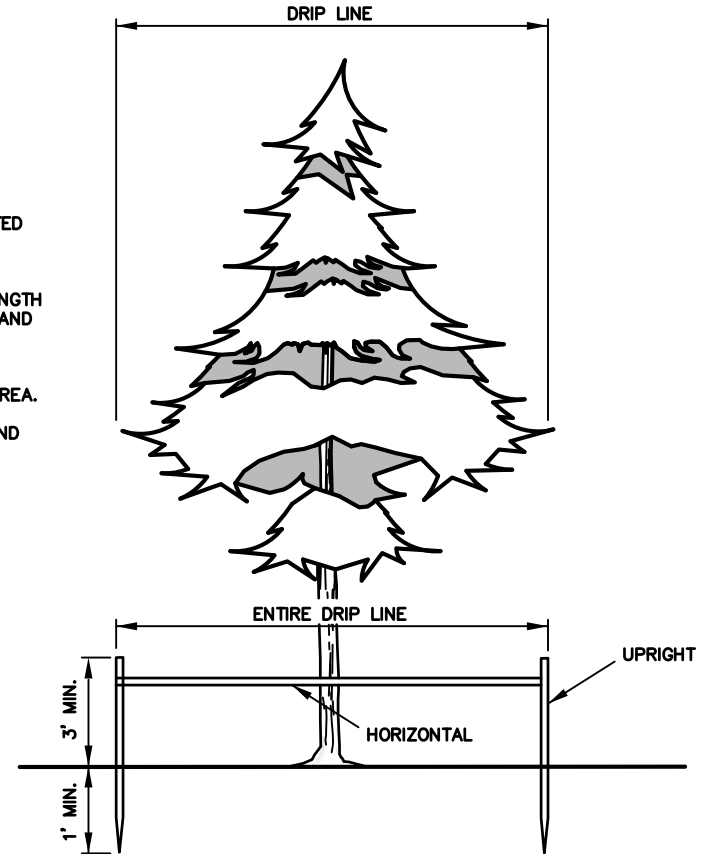

SPECIFICATIONS – WOOD BARRIER

1. MINIMUM RADIUS TO BE PROTECTED:
 - A. HARDWOODS – 2/3 DRIPLINE
 - B. CONIFERS & SABAL PALMS – ENTIRE DRIPLINE.
 2. UPRIGHTS – NO LESS THAN 2" X 2" LUMBER.
 3. HORIZONTALS – NO LESS THAN 1" X 4" LUMBER.
 4. BARRIERS SHALL BE ERECTED AROUND ALL PROTECTED TREES AND PALMS, AND INSPECTED BY CITY REPRESENTATIVE BEFORE CONSTRUCTION BEGINS.
 5. UPRIGHT POSTS ARE TO BE AT LEAST 4 FEET IN LENGTH WITH A MINIMUM OF 1 FOOT ANCHORED IN GROUND AND 3 FEET ABOVE GROUND.
 6. BARRIERS TO REMAIN IN PLACE UNTIL ALL PAVING, CONSTRUCTION AND HEAVY EQUIPMENT IS OUT OF AREA.
- FURTHER INFORMATION MAY BE OBTAINED FROM THE LAND RESOURCE SPECIALIST AT 562-4741.

TREE BARRICADES

CLEARWATER INDEX No. 909, SH. 1 of 1
 Rev. 4/09/03
 N.T.S.

				CITY OF CLEARWATER, FLORIDA ENGINEERING DEPARTMENT	
				REDRAWN BY P.W.D.	DATE 4/09/03
				CHECKED BY T.M.K.	INDEX NO. 909
				DESIGNED BY T.M.K.	1 OF 1
1	5/17/12	DEPARTMENT NAME	TLM	TREE BARRICADES DETAIL	
REV.	DATE	DESCRIPTION	APP.		

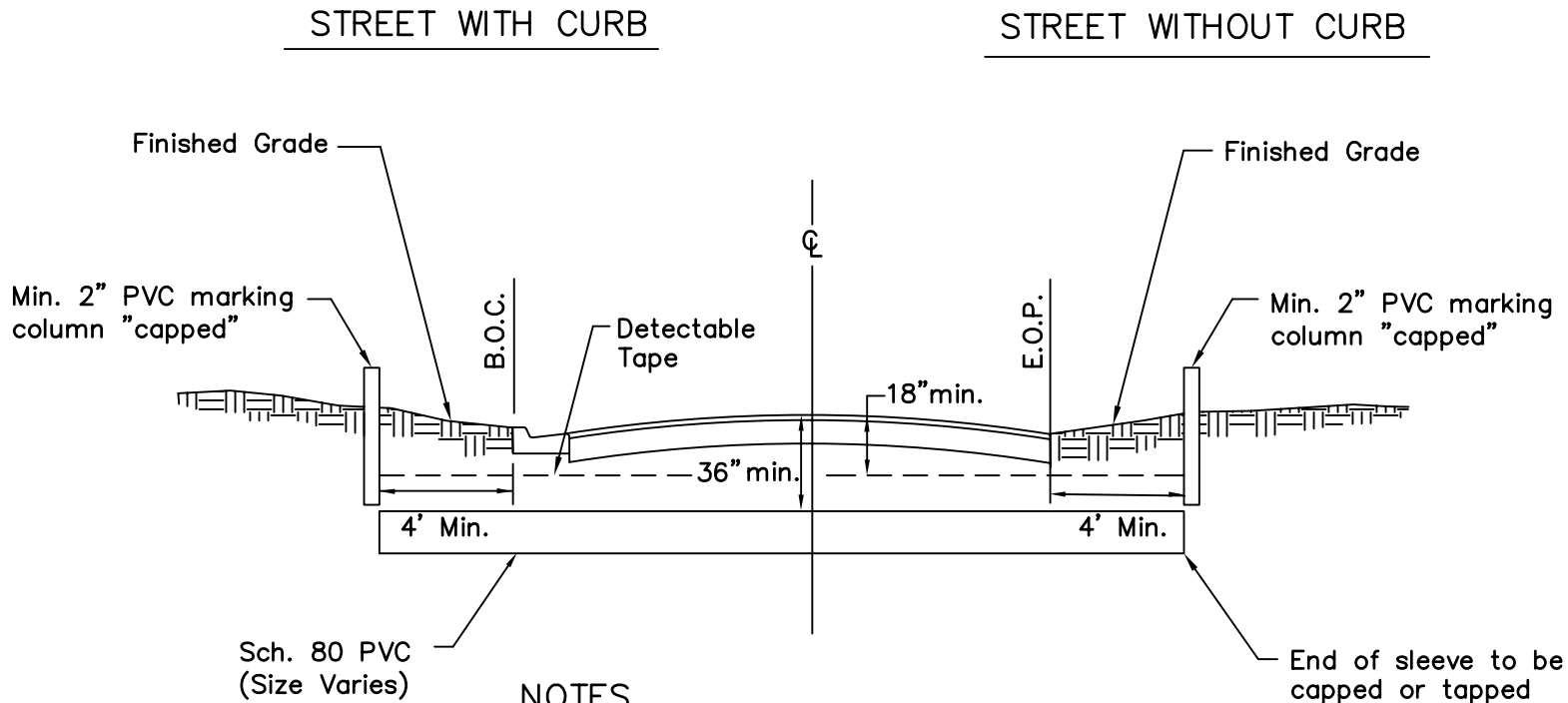

NOTES

- 1. 2" PVC marking Columns to be set 12" above existing grade at each end of PVC sleeves.

End of sleeve to be capped or tapped (typical each end)

TYPICAL IRRIGATION SLEEVE

CITY INDEX NO. 910; SHEET 1 OF 1
N.T.S.

				CITY OF CLEARWATER, FLORIDA ENGINEERING DEPARTMENT		
				REDRAWN BY DL	TYPICAL IRRIGATION	DATE 04/25/08
				CHECKED BY T. KURTZ	SLEEVE	INDEX NO. 910
REV.	DATE	DESCRIPTION	APP.	DESIGNED BY T. KURTZ		1 OF 1